

PEML[®]

Sampling valve with Membrane & Lever for tanks or process lines and low viscosity liquids

Presentation

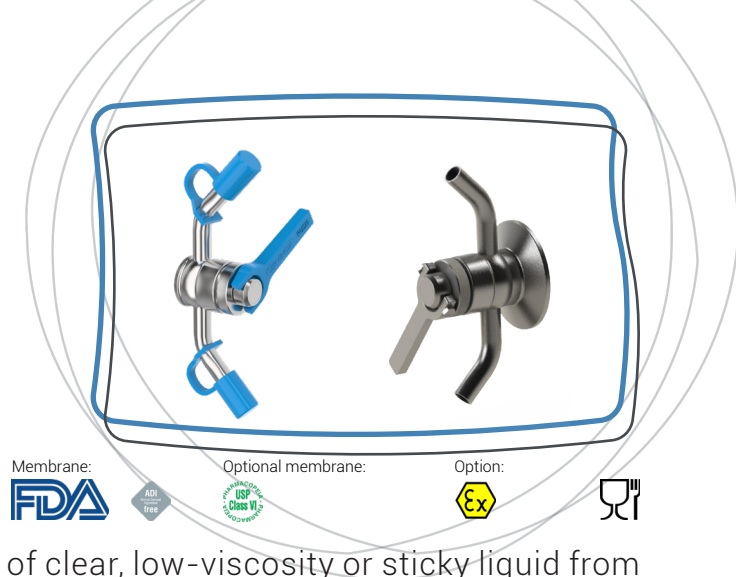

The PEML sampling valve is used to take a sample of clear, low-viscosity or sticky liquid from a process line or a tank, in order to carry out quality and/or bacteriological tests. The PEML valve is available in manual and automatic versions. The valve has a dedicated connection for the flow of CIP fluid, enabling the sampling chamber to be cleaned. The control head offers 2 opening positions: kept open and opening with spring-loaded automatic closing. Its reinforced "flush membrane" (flared body) type hygienic design, ensures that there are no retention areas (where bacteria can develop), and that it is easy to clean. Sealed with a membrane coupled to the drive head.

Key features

- Specially designed for liquids that are sticky and/or have a low pressure head
- Hygienic design with flush body
- Can be sterilised by CIP/SIP circulation
- Operational safety (spring-loaded automatic closing)
- Ease of assembly and maintenance
- Available in manual and automatic versions

Applications

- Sampling on tanks or lines conveying sticky, sugary, low-solidification rate, low-viscosity or clear liquids
- Equipment particularly suited to sampling products subject to quality and/or bacteriological tests

Technical features

Sizes: DN 6 and DN 10

Inlet fitting: Welding

Outlet fitting: Plain nozzle with VMQ cap (Silicone)

CIP connection: Plain nozzle with VMQ cap (Silicone)

Operating pressure: From -1 to 6.0 bar for DN 6 and 5 bar for DN 10

Operating temperature: From 1°C to 120°C

Withstands CIP/SIP: Up to 130°C for 20 to 30 minutes

Materials

- Parts in contact with the product: Stainless steel 1.4404 (316L)
- Other parts: Stainless steel 1.4307 (304L)
- Sealing: VMQ (Silicone) membrane
- Lever: Stainless steel or glass-fibre filled polyamide

Dimensions in mm

Sizes	A	B	D
DN 6 (elbow outlet)	51	56	24.5
DN 10 (elbow outlet)	52	76	34.5

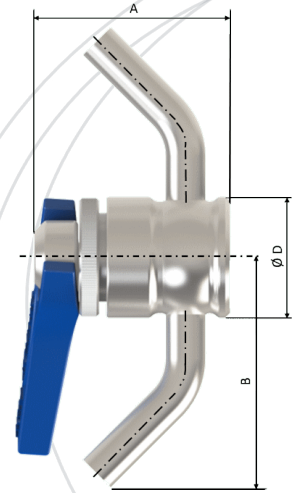

Options

- Automatic version (single-acting or double-acting cylinder)
- Automatic version with opening detection
- Opening without blocking (dead man)
- Valve without CIP connection for flame sterilisation (silicone cap not included)
- Stainless steel screw caps or aseptic caps
- Other membranes: EPDM (Ethylene Propylene Diene Monomer), FKM (Fluorocarbon rubber, eq. Viton®), NBR (Nitrile rubber)
- Customised equipment: please contact us
- All types of connection on request (inlets and outlets)

Warranty

12 months as from the date of dispatch (except for special conditions)

Conformity

- Pipe fitting and tank compliant with Paragraph 4.3 of the PED 2014/68/EU
- Option: "ATEX 2014/34/EU, zones 1 & 2, gas and dust" compliant for automatic versions without opening detection
- Membranes compliant with FDA CFR 21.177.2600 and Regulation (EC) 1935/2004
- Option: Membrane compliant with USP Class VI